



Roku Quick Start Guide

Roku Quick Start Guide

A Roku is a device that allows you to stream services such as Netflix, Hulu and Disney+ without having a smart TV or subscriptions to the streaming services.

- ITPLD Members only
- Holdable
- 3 week check-out with no renewals

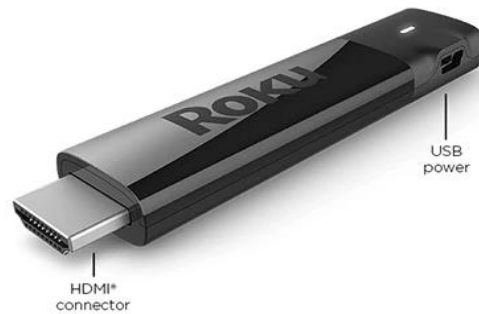

Inside the Case:

Each item is labeled by its number and the items are listed under which device they belong to.

Roku

1. Roku Stick
2. Roku Remote & extra batteries
3. USB Power Cable & Extender Cable
4. Roku Wall Plug

Wi-Fi

5. Mobile Wi-Fi Unit
6. Mobile Wi-Fi Unit Charging Cable

Handouts

- ITPLD Roku Quick Start Guide
- ITPLD Mobile Wi-Fi Unit Quick Start Guide

Get Connected

- Put the Roku Stick (1) in an available HDMI port in your TV or Computer.
- Connect the USB Power Cable (3) to the USB port in your TV or Computer. (*Top image*)
- **If your device does NOT have a USB port**, then plug the USB Power Cable (3) into an outlet using the Roku Wall Plug (4).
- **If using it on a TV**, select which HDMI port you want to use for the Roku Stick (it may automatically open to Roku.)
 - Look for "Roku" or "Roku Stick".
- Enter your personal Wi-Fi information into the TV or Computer once connected. A mobile Wi-Fi unit has been provided in the Roku case if you do not have Wi-Fi at home.
 - Select Settings - Network - Set Up Connection - Wireless
 - Select either personal internet connection or the mobile Wi-Fi units.

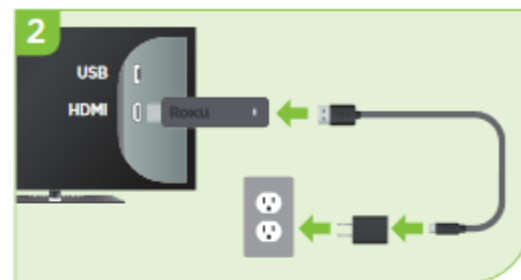

OR

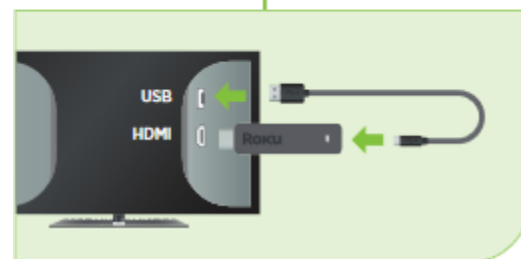

No internet at home? Wirelessly Connect to Your Device Using the Wi-Fi Hotspot.

- Use the Wi-Fi unit (6) provided with your Roku to connect to the internet.
- Turn on the Wi-Fi unit. It may need to be plugged in using the USB C Cable (7) and the Large Wall Plug (8) to keep its charge.
- Click the power button to get the Wi-Fi name and password from the device
 - Click the power button for the Wi-Fi name that will begin with Franklin T
 - Click the power button again for the Wi-Fi password.
- Enter both the Wi-Fi name and password into the device you want to connect to the internet, in the Wi-Fi settings.
 - From your device, select the wireless network name as displayed by the Hotspot (**name starts with Franklin T**). Click on "connect" and then when prompted, enter the wireless password.

Roku Parental Controls Guide

To access the main Netflix, Hulu and Disney Plus accounts, you will need to enter in the PIN. If you want age-appropriate content only, select the default Kids Profile, or ITPLD Kids profile. Any new profiles created will be deleted upon return to the library. **Confirm which Roku Subscription you have checked out.**

Revised: 1/30/25



Roku Quick Start Guide

Netflix

- Main account PIN: 2021
- Use the default Kids Profile

Hulu

- Main account PIN: 2021
- Select ITPLD Kids

Apple TV

- **No ability to limit. Users have access to all content.**

En Español

- Univision: Content rated over TV-14 requires PIN: 2021
- ViX: **No ability to lock main account.** Select ITPLD Niños profile (rated up to TV-14)

Amazon Prime

- **No ability to limit. Users have access to all content.**

Disney+

- Main account PIN: 2021
- Select ITPLD Kids Profile

Max

- Main account PIN: 2021
- Select ITPLD Kids Profile

Anime (Crunchyroll)

- **No ability to lock main account.**
- Select Kids profile (rated up to 12+)

Kanopy

- Use the default Kids Profile
- Set up Parental Controls

Note: Parental Controls in Kanopy is Kanopy Kids, and a PIN is needed to leave the Kids Profile

- Navigate to your Profile Name in the top right
- Select Parental Controls
- Select "Turn On" in Orange
- Choose a 4-digit PIN
- Select Save PIN

Start Watching

- With the Roku, the library provides access to the following subscriptions:
 - **Netflix, Hulu, Disney+, ESPN+, Amazon Prime, Max, Crunchyroll, & En Español (ViX & Sling)**
- Use the Roku remote to navigate which streaming service you would like to use. **Extra batteries are provided for the remote.**
- PINs are set for Netflix, Hulu and Disney Plus to watch on the main account
 - Netflix, Hulu, and Disney + PIN: 2021
- PIN set to exit Max.
 - Max PIN: 2021
- All passwords for the library provided streaming services are saved onto the Roku. If you are unable to login you will need to come to the library for staff to enter the username and password. **Passwords cannot be given out over the phone.**
 - **Kanopy** and **Hoopla** can be accessed with your username/password or library card account.

Contents and Replacement Fees

- Roku: \$48
- Mobile Wi-Fi Unit: \$90
- (2) Wall charger \$10
- (3) USB Cords \$5
- Device Case: \$13

Return To the Library

- When your checkout period is over, return the Wi-Fi Hotspot device to a staff member at the Adult Services desk. **DO NOT** return the device in the book drop or return belt.

For more assistance:

- Call us at 847-459-4100 extension 3 to set up a free one-on-one session.
- Email us at adult@itpld.org.
- Stop by the Adult Services Desk for a quick in-person tutorial of our eResources.
- Also, be sure to visit: itpld.info/downloadables to keep up-to-date with our latest eResources.

Revised: 1/30/25

Indian Trails Public Library District • 355 Schoenbeck Rd., Wheeling IL 60090 • 847.459.4100 • www.itpld.org